



Thread Reducers: Nickel Plated Brass Ex-d/Ex-e - Metric Threads						
Part Numbers		Thread Type & Size		Dimensions in Inches (mm)		
-4°F to 203°F (-20°C to 95°C)	-76°F to 356°F (-60°C to 180°C)	Male Thread A	Female Thread B	H	T	X
				Overall Height	Thread Length	Wrench Flat
w/ Buna-N O-Ring	w/ Silicone O-Ring	Page 59 for Thread Specs	Page 59 for Thread Specs			
RM-1612-MX-D	RM-1612-MIX-D	M16 x 1.5	M12 x 1.5	.75" (19)	.63" (16)	.75" (19)
RM-2012-MX-D	RM-2012-MIX-D	M20 x 1.5	M12 x 1.5	.77" (19.5)	.63" (16)	.87" (22)
RM-2016-MX-D	RM-2016-MIX-D	M20 x 1.5	M16 x 1.5	.77" (19.5)	.63" (16)	.87" (22)
RM-2516-MX-D	RM-2516-MIX-D	M25 x 1.5	M16 x 1.5	.77" (19.5)	.63" (16)	1.18" (30)
RM-2520-MX-D	RM-2520-MIX-D	M25 x 1.5	M20 x 1.5	.77" (19.5)	.63" (16)	1.18" (30)
RM-3216-MX-D	RM-3216-MIX-D	M32 x 1.5	M16 x 1.5	.81" (20.5)	.63" (16)	1.61" (41)
RM-3220-MX-D	RM-3220-MIX-D	M32 x 1.5	M20 x 1.5	.81" (20.5)	.63" (16)	1.61" (41)
RM-3225-MX-D	RM-3225-MIX-D	M32 x 1.5	M25 x 1.5	.81" (20.5)	.63" (16)	1.61" (41)
RM-4020-MX-D	RM-4020-MIX-D	M40 x 1.5	M20 x 1.5	.83" (21)	.63" (16)	1.81" (46)
RM-4025-MX-D	RM-4025-MIX-D	M40 x 1.5	M25 x 1.5	.83" (21)	.63" (16)	1.81" (46)
RM-4032-MX-D	RM-4032-MIX-D	M40 x 1.5	M32 x 1.5	.83" (21)	.63" (16)	1.81" (46)

Silicone version accommodates  
**-60°C**   
 Temperature



Ex-d EXIOS  
Cable Glands

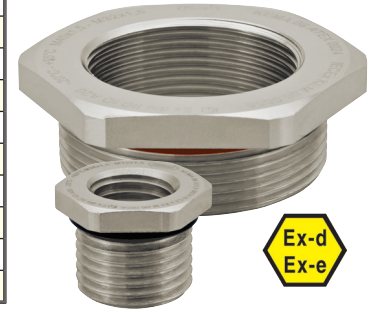
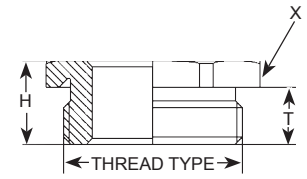

Ex-d Nickel Plated Brass &  
Stainless Steel Glands

Ex-e  
Nylon Glands

Ex-e Multi-Hole &  
Romex Glands

**Thread Reducer - Accessories**

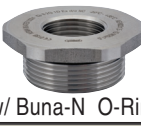
**(316L) Stainless Steel - Metric - Ex-d/Ex-e**

Thread Reducers: (316L) Stainless Steel (INOX) Ex-d /Ex-e - Metric Threads						
Part Numbers		Thread Type & Size		Dimensions in Inches (mm)		
-4°F to 203°F (-20°C to 95°C)	-76°F to 356°F (-60°C to 180°C)	Male Thread A	Female Thread B	H	T	X
				Overall Height	Thread Length	Wrench Flat
w/ Buna-N O-Ring	w/ Silicone O-Ring	Page 59 for Thread Specs	Page 59 for Thread Specs			
RM-1612-6X-D	RM-1612-6IX-D	M16 x 1.5	M12 x 1.5	.75" (19)	.63" (16)	.75" (19)
RM-2012-6X-D	RM-2012-6IX-D	M20 x 1.5	M12 x 1.5	.77" (19.5)	.63" (16)	.87" (22)
RM-2016-6X-D	RM-2016-6IX-D	M20 x 1.5	M16 x 1.5	.77" (19.5)	.63" (16)	.87" (22)
RM-2516-6X-D	RM-2516-6IX-D	M25 x 1.5	M16 x 1.5	.77" (19.5)	.63" (16)	1.18" (30)
RM-2520-6X-D	RM-2520-6IX-D	M25 x 1.5	M20 x 1.5	.77" (19.5)	.63" (16)	1.18" (30)
RM-3216-6X-D	RM-3216-6IX-D	M32 x 1.5	M16 x 1.5	.81" (20.5)	.63" (16)	1.61" (41)
RM-3220-6X-D	RM-3220-6IX-D	M32 x 1.5	M20 x 1.5	.81" (20.5)	.63" (16)	1.61" (41)
RM-3225-6X-D	RM-3225-6IX-D	M32 x 1.5	M25 x 1.5	.81" (20.5)	.63" (16)	1.61" (41)
RM-4020-6X-D	RM-4020-6IX-D	M40 x 1.5	M20 x 1.5	.83" (21)	.63" (16)	1.81" (46)
RM-4025-6X-D	RM-4025-6IX-D	M40 x 1.5	M25 x 1.5	.83" (21)	.63" (16)	1.81" (46)
RM-4032-6X-D	RM-4032-6IX-D	M40 x 1.5	M32 x 1.5	.83" (21)	.63" (16)	1.81" (46)

Silicone version accommodates  
**-60°C**   
 Temperature

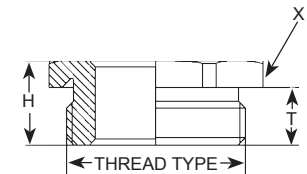

Ex-e Nickel Plated Brass &  
Stainless Steel Glands

Ex-e EMI / RFI Nickel  
Plated Brass Glands

Ex-e / Ex-d  
Accessories

***More Ex-d/Ex-e Adapters & Reducers  
 Options Available!***

**Sizes:** Please Inquire  
**Thread Type:** NPT, Metric, PG

**Materials:** Nylon, Bare Brass  
**Ratings/Approvals:** Class/Division